

ORDNANCE SURVEY COPY RIGHT  
Based or reproduced from the 2008  
Ordnance Survey 1/1000 base with the  
permission of HMSO crown copyright  
reserved. License No. LA-100019671

**CURRENT**

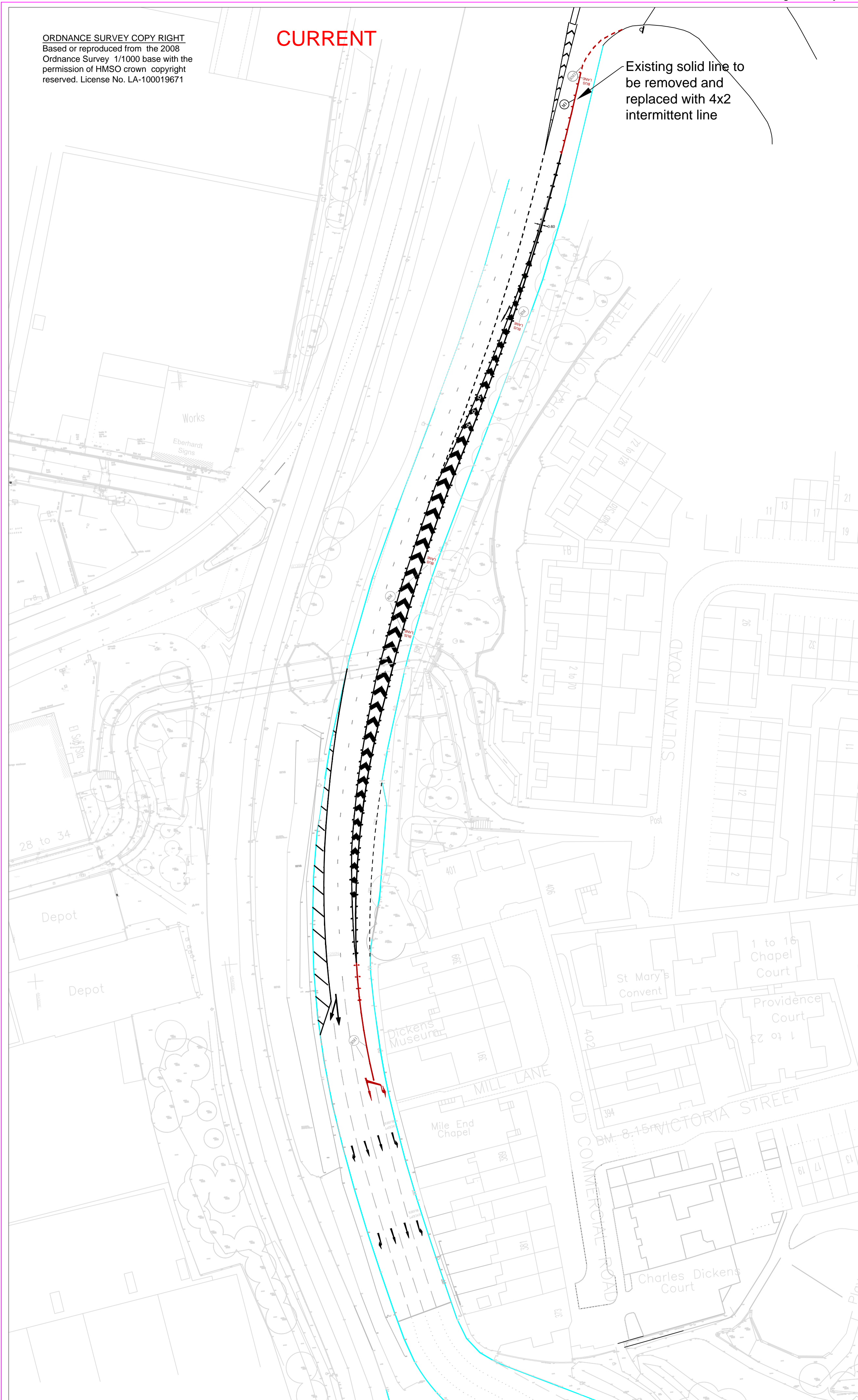

**PROPOSED**

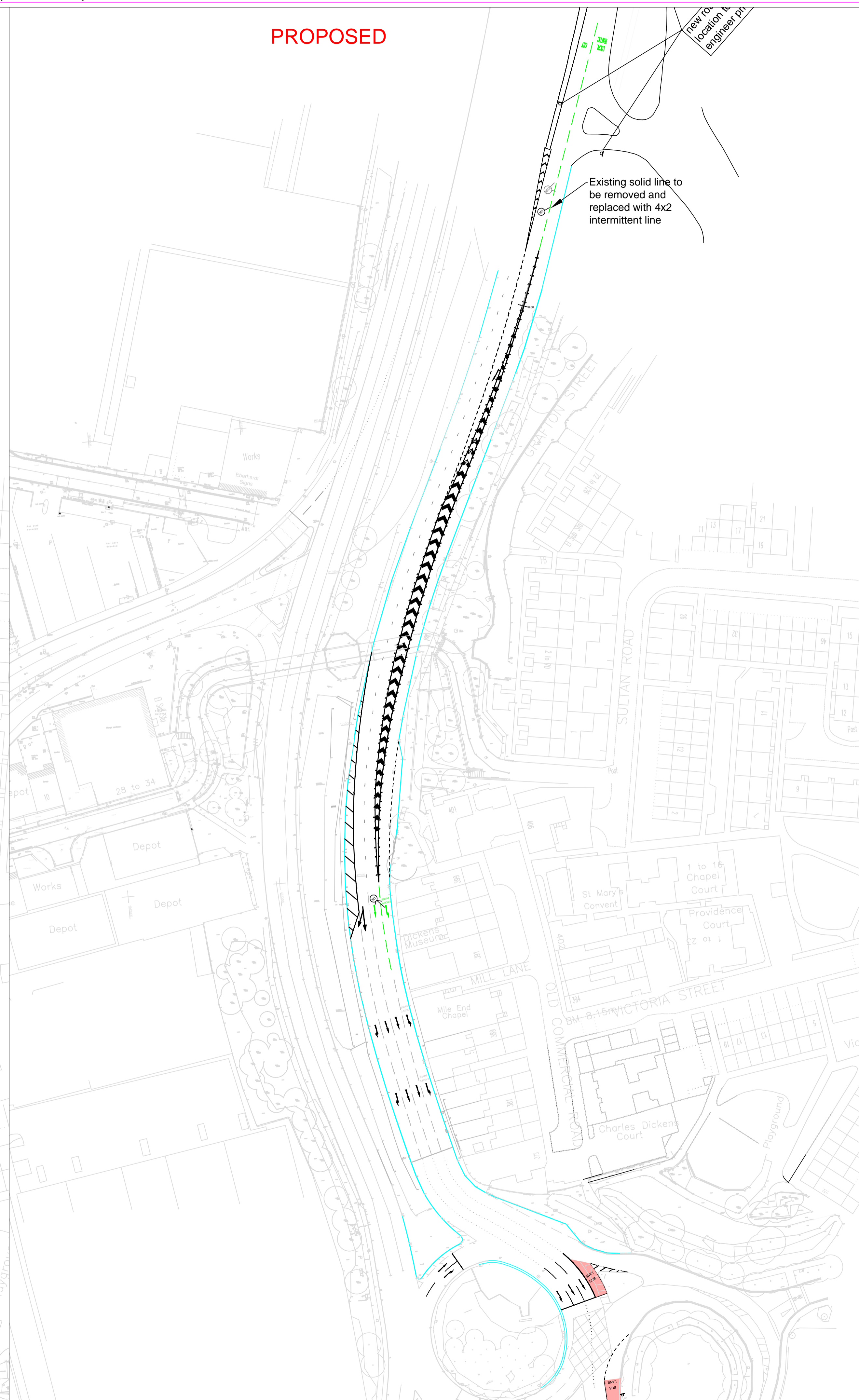

**NOTE:** All dimensions to be checked on site prior to commencement of any work  
\*\*\* DO NOT SCALE FROM THIS DRAWING \*\*\*  
Notify C.A. of any discrepancies before ordering materials.

**KEY**

- (M1) New road marking or existing road markings to be refreshed in **GREEN**
- (RM1) Existing road marking to be removed in **RED**.
- 3M Marker Series 290 road stud with a red reflector to face oncoming traffic to be removed.

**NOTES**

- 1) All roadmarkings are to be removed by an appropriate method, suitable for the existing carriageway type. Contractor is to ensure that they allow for this in their rate buildup.
- 2) All road markings and signs to comply with The Traffic Signs Regulations and General Directions 2002 and subsequent amendments in 2011.
- 3) Please refer to the lining schedules for further details of road marking sizes as appropriate.
- 4) The location of line markings and signs are to be confirmed by site engineer prior to installation
- 5) The chevrons annotated with M1 are to be in accordance with TSRGD diagrams 1042 and 1042.1.
- 6) The boundary line marked M1 is to be painted twice to enable it to stand out more clearly.
- 7) All dimensions are in metres.

Rev	Date	Revision Details (Amended by)	Approved by

Project  
**MILE END ROAD  
BUS LANE**

Drawing Title  
**ROAD MARKING  
AMENDMENTS**

Date: JAN 2014 Scale: NOT TO SCALE

**Portsmouth  
CITY COUNCIL**  
TRANSPORT AND ENVIRONMENT SERVICE

HEAD OF TRANSPORT AND ENVIRONMENT Tel No: 023 9283 4955  
SIMON MOON BTch MBA MHT Fax No: 023 9283 4866

Design/Survey by: EB/YV Drawn by: SF Checked by: SB

Drawing No	Revision No.

SURVEY	DESIGN	WORKING DRAWINGS
FEASIBILITY	TENDER	AS-BUILT
INFORMATION	CONTRACT	4 1